

1mm	Socket	Single Row - Barrel Contact	Straight	Thru Hole
-----	--------	-----------------------------	----------	-----------

1mm Center Single Row Socket - round barrel contact

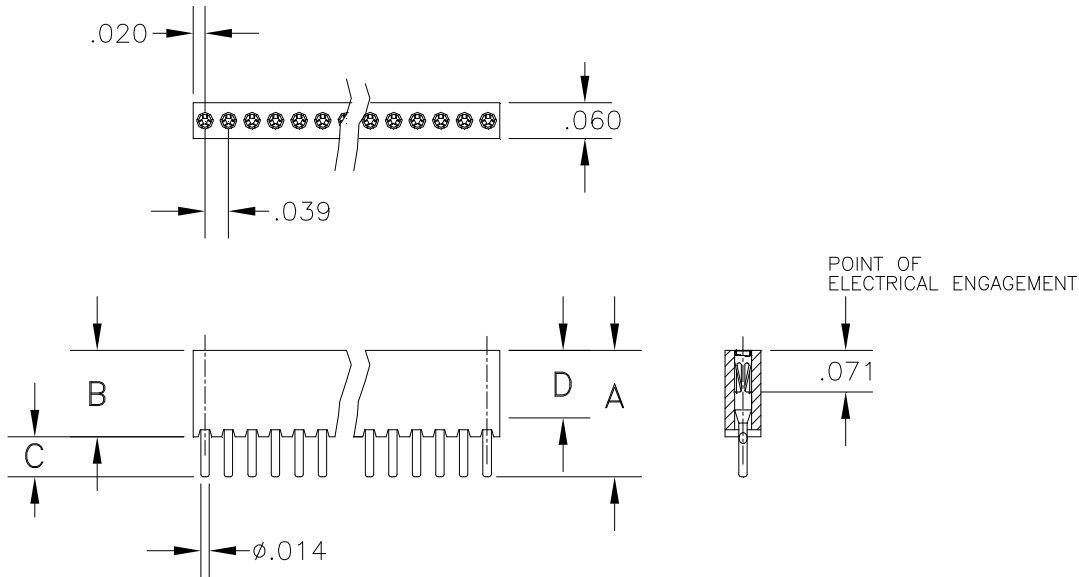

Base Part Number	A		B		C		D		E		Plating Options	Number of Postions
	mm	Inch	mm	Inch	mm	Inch	mm	Inch	mm	Inch		
6401	4.57	0.180	3.68	0.145	0.89	0.035	2.79	0.110			G1	2-40
6402	5.59	0.220	3.68	0.145	1.90	0.075	2.79	0.110			G1	2-40
6404	6.35	0.250	3.68	0.145	2.67	0.105	2.79	0.110			G1	2-40
6403	7.62	0.300	3.68	0.145	3.94	0.155	2.79	0.110			G1	2-40

Technical Notes	
Contact Material:	Contact: Stamped - BeCu
Insulation Material:	Glass Filled Nylon 46 - UL 94V-0 rated - Black (std)
Heat Deflection:	260°C @ 264 PSI per ASTM D648
Insulation Resistance:	5000 MegOhm @ 500VDC
Current Rating:	1 amps continuous @ 100 VDC/contact
Max Processing Temp:	250°C for 60 seconds
Insertion Force:	75 grams (2.6 oz) (typical initial w/ .012 inch square pin)
Extraction Force:	49 grams (1.7 oz) (typical initial w/ .012 inch square pin)
Plastic:	High Temperature Plastic
INTERCONNECT SYSTEMS INC.	
741 Flynn Road, Camarillo, Ca 93012 · (805) 482-2870 · fax (805) 482-8470 · e-mail: info@isipkg.com	