

REV	DESCRIPTION	DATE	BY
A	NEW DRAWING	11/09/16	RF

SKT4313

[TOP SIDE]

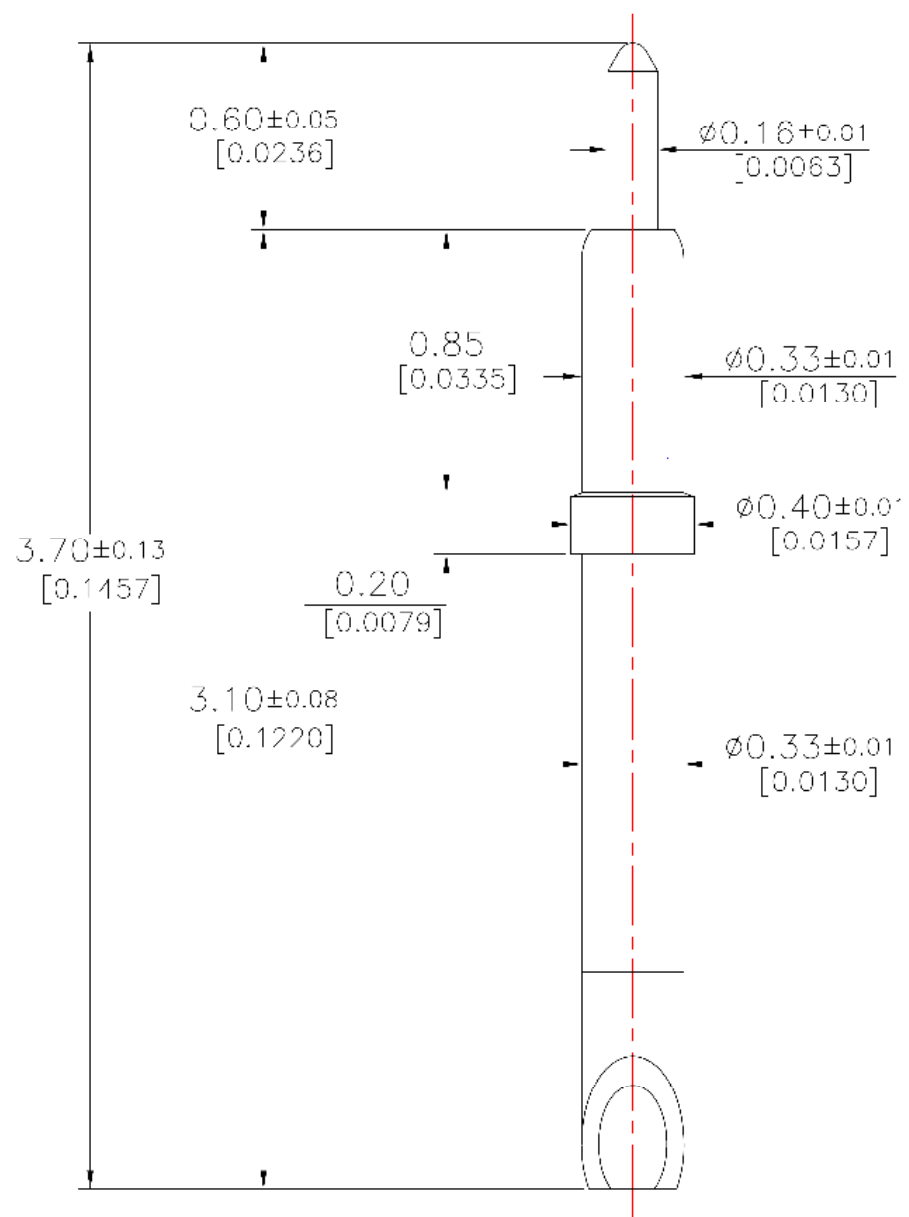

[BOTTOM SIDE]

Pointing Accuracy: ± 0.05 mm

Spring Force: ± 30%

STATE	TRAVEL	SPRING FORCE
Initial Travel	--	3.3g (0.117oz)
Recommended Travel	0.38mm (0.0150")	12.0g (0.422oz)
Full Travel	0.51mm (0.0201")	14.9g (0.527oz)

PART	MATERIAL	FINISH
Spring	Stainless Steel	Gold Plated
Barrel	Phosphor Bronze	Gold Plated
Top Plunger	Hardened Beryllium Copper	Gold Plated
Bottom Terminal	Hardened Beryllium Copper	Gold Plated

***Notice:** The assembly point diameter of the terminal and barrel could be 0.01mm greater than the max tolerance of the barrel. The working travel of the pin needs to be considered in the housing design due to a 0.13mm difference between the recommended and full travel of the plunger. Should the actual working travel exceed 0.38mm the device, spring and/or pcb pad can be damaged.

ALL DIMENSIONS ARE IN MILLIMETERS UNLESS OTHERWISE SPECIFIED

EMULATION TECHNOLOGY, INC.
 VLSI and SMT ADAPTERS and ACCESSORIES

741 FLYNN ROAD
 CAMARILLO, CA 93012

TEL: (805) 383-8480
 FAX: (805) 383-8484

SHEET: 1 OF 1	DATE: 11/09/16	REVISION: A	ASSEMBLY DRAWING
CHECKED:	PREPARED BY: R. FLORES	ITEM: POGO-PIN-3.70-1	
DO NOT SCALE DRAWING			DESCRIPTION: POGO-PIN-3.70-1