

Catalog Page 93-1

.100	Jumper	Single Shunt	Insulated
-------------	---------------	---------------------	------------------

.100 inch Center Microshunt Open & Closed Top Single Jumper

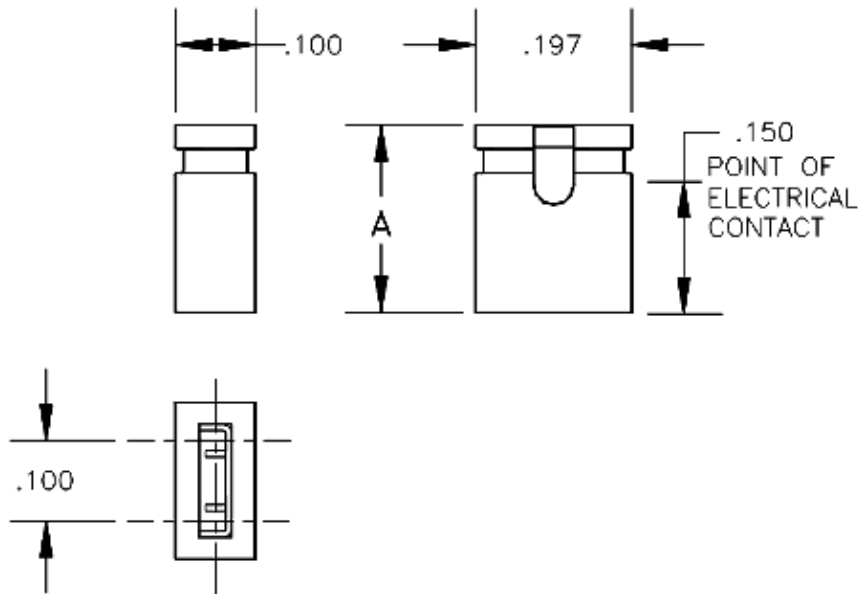

Base Part Number	A		B		C		D		E		Plating Options	Number of Postions
	mm	Inch	mm	Inch	mm	Inch	mm	Inch	mm	Inch		
CCIJ-185 Open Top	4.70	0.185									G : TLF	OPEN TOP
CCIJ-235 Open Top	5.97	0.235									G : TLF	OPEN TOP
CTIJ-255 Closed Top	6.48	0.255									G : TLF	CLOSED TOP
CCIJ-315 Open Top	8.00	0.315									G : TLF	OPEN TOP
CTIJ-315 Closed Top	8.00	0.315									G : TLF	CLOSED TOP

+

Technical Notes	
Contact Material:	Contact: Phosphor Bronze
Insulation Material:	Thermoplastic - UL 94V-0 rated
Insulation Resistance:	5000 MegOhm @ 500VDC
Current Rating:	1 amps continuous @ 100 VDC/contact
Max Processing Temp:	105°C for 60 seconds
Insertion Force:	200 grams(7.0oz)
Extraction Force:	120 grams(4.2oz)
INTERCONNECT SYSTEMS INC.	
741 Flynn Road, Camarillo, Ca 93012 · (805) 482-2870 · fax (805) 482-8470 · e-mail: info@isipkg.com	